

# EAST SIDE UNION HIGH SCHOOL DISTRICT SANTA TERESA HIGH SCHOOL

## DW INFRASTRUCTURE - PLAY COURT IMPROVEMENTS PROJECT NO. Z-070-705

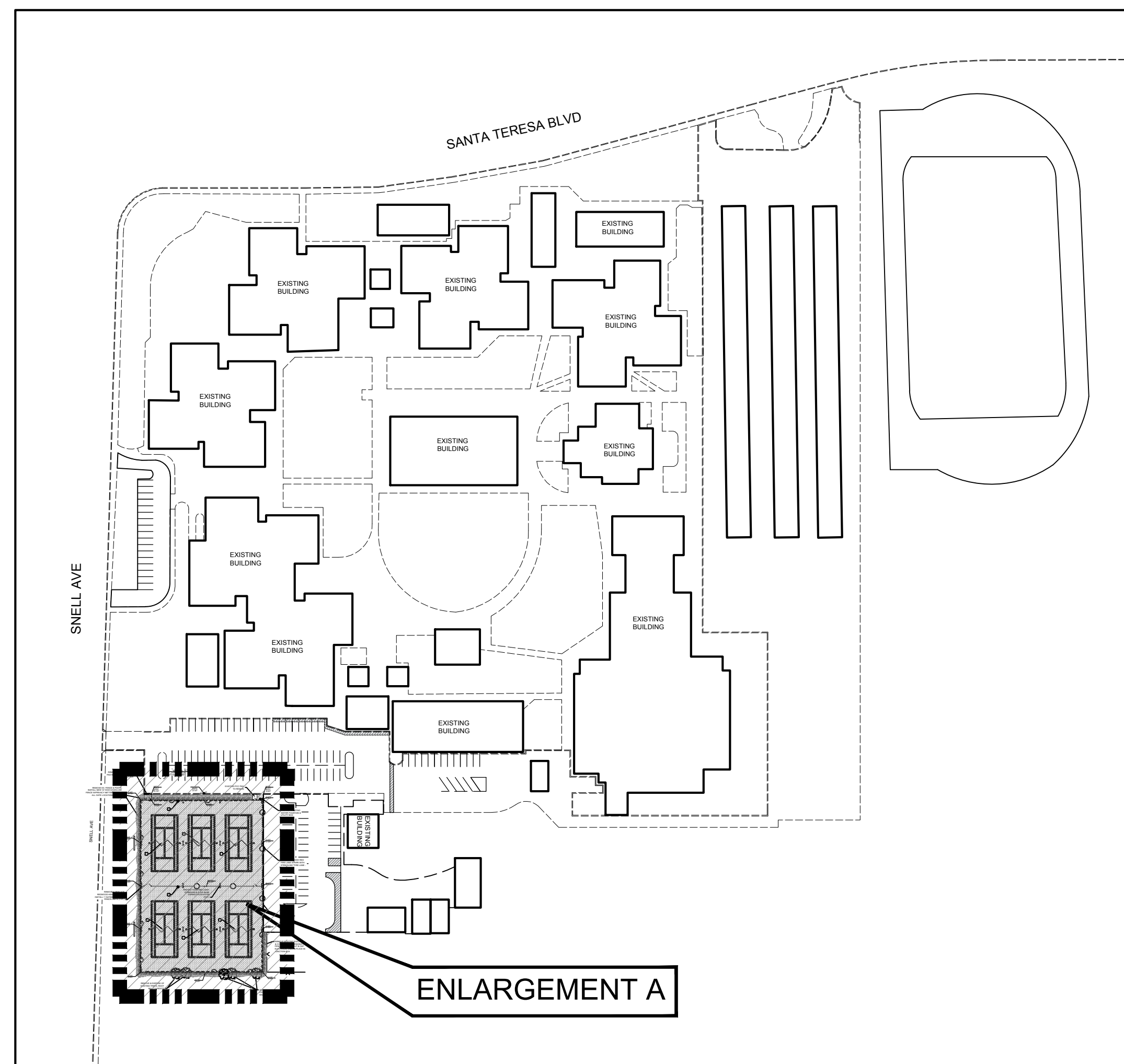

**SITE PLAN**  
 1" = 140'

SHEET INDEX	
SHEET NO.	SHEET TITLE
1	TITLE PAGE
2	ENLARGEMENT A
3	DETAILS

**NOTES:**

1. CONTRACTOR SHALL BE RESPONSIBLE FOR ANY AND ALL TESTING THAT MAY BE REQUIRED TO LEGALLY DISPOSE OF EXCESS MATERIAL.
2. ALL WORK SHALL BE PERFORMED IN ACCORDANCE WITH THE PLANS & CONTRACT DOCUMENTS. WORK NOT COMPLYING WITH PLANS & CONTRACT DOCUMENTS WILL BE SUBJECT TO REMOVAL AND REPLACEMENT AT THE CONTRACTORS EXPENSE.
3. THE CONTRACTOR SHALL REMOVE ALL CONSTRUCTION DEBRIS AND LEAVE WORK AREA CLEAN DAILY.
4. ALL MATERIALS AND WORKMANSHIP ARE SUBJECT TO REVIEW BY OWNER. ANY PORTION OF THE WORK DEFECTIVE SHALL BE REPLACED BY THE CONTRACTOR AS PART OF THIS CONTRACT AT NO ADDITIONAL COST TO THE OWNER.
5. ABSOLUTE ACCURACY OF DRAWING CAN NOT BE GUARANTEED. WHILE EVERY EFFORT HAS BEEN MADE TO COORDINATE THE LOCATION OF THE EXISTING EQUIPMENT, PIPING, ETC. IT IS THE RESPONSIBILITY OF THE CONTRACTOR TO COORDINATE THE EXACT REQUIREMENTS GOVERNED BY ACTUAL JOB CONDITIONS.
6. AREAS NOT IN SCOPE OF WORK DISTURBED DURING CONSTRUCTION SHALL BE RESTORED TO THE EXISTING CONDITION AT THE CONTRACTORS EXPENSE.
7. PROTECT EXISTING BUILDING STRUCTURES, AND ADJACENT FINISHED SURFACES DURING CONSTRUCTION. PATCH, REPAIR AND REFINISH AREAS DAMAGED OR IMPACTED BY WORK DURING THIS PROJECT TO MATCH ADJACENT UNDISTURBED AREAS. PATCHING, REPAIRING AND REFINISHING IS TO BE PERFORMED BY WORKMEN SKILLED IN THE TRADES INVOLVED.
8. CONTRACTOR SHALL HAVE LOCATING SERVICE VERIFY LOCATION OF ALL EXISTING UTILITIES PRIOR TO EXCAVATION. CONTRACTOR SHALL CONTACT THE ENGINEER TO REVIEW AND ADDRESS ANY UTILITIES CONFLICTING WITH THE SCOPE OF WORK.
9. UTILITY BOXES IN CONSTRUCTION AREAS SHALL BE REUSED AND ADJUSTED TO FINISHED GRADE. IF BOXES ARE NOT REUSABLE, CONTRACTOR SHALL NOTIFY ENGINEER PRIOR TO REMOVAL.
10. ANY AND ALL IRRIGATION LINES AND SPRINKLERS IN WORK AREA SHALL BE RELOCATED OUTSIDE LIMITS OF NEW BASKETBALL COURT AREA.

Path: Z:\SHARED\DRIVE\ACTIVE PROJECTS\EAST SIDE UHSD\180390-01\_SANTA TERESA TENNIS DRAWINGS\180390 DESIGN\DWG Plot Date: 2/9/2019 3:56 PM

REV	DATE	DESCRIPTION	APP

**Pavement Engineering Inc.**  
 You can ride on our reputation  
 Corporate Office:  
 3485 Sacramento Drive, Suite A  
 San Luis Obispo, CA 93401  
 805.781.2265

SANTA TERESA HIGH SCHOOL  
 6150 SNELL AVENUE, SAN JOSE, CA  
 DW INFRASTRUCTURE - PLAY COURT IMPROVEMENTS  
 TITLE PAGE

DRAWN BY: **TL5**  
 PROJECT NUMBER: **180390-01**  
 SCALE: **1" = 140'**  
 DATE: **JAN. 2019**  
 SHEET NUMBER:

Path: Z:\SHARED\DRIVE\ACTIVE PROJECTS\EAST SIDE UHSD\180390-01\_SANTA TERESA TENNIS DRAWINGS\180390 DESIGN\DWG Plot Date: 2/9/2019 3:56 PM

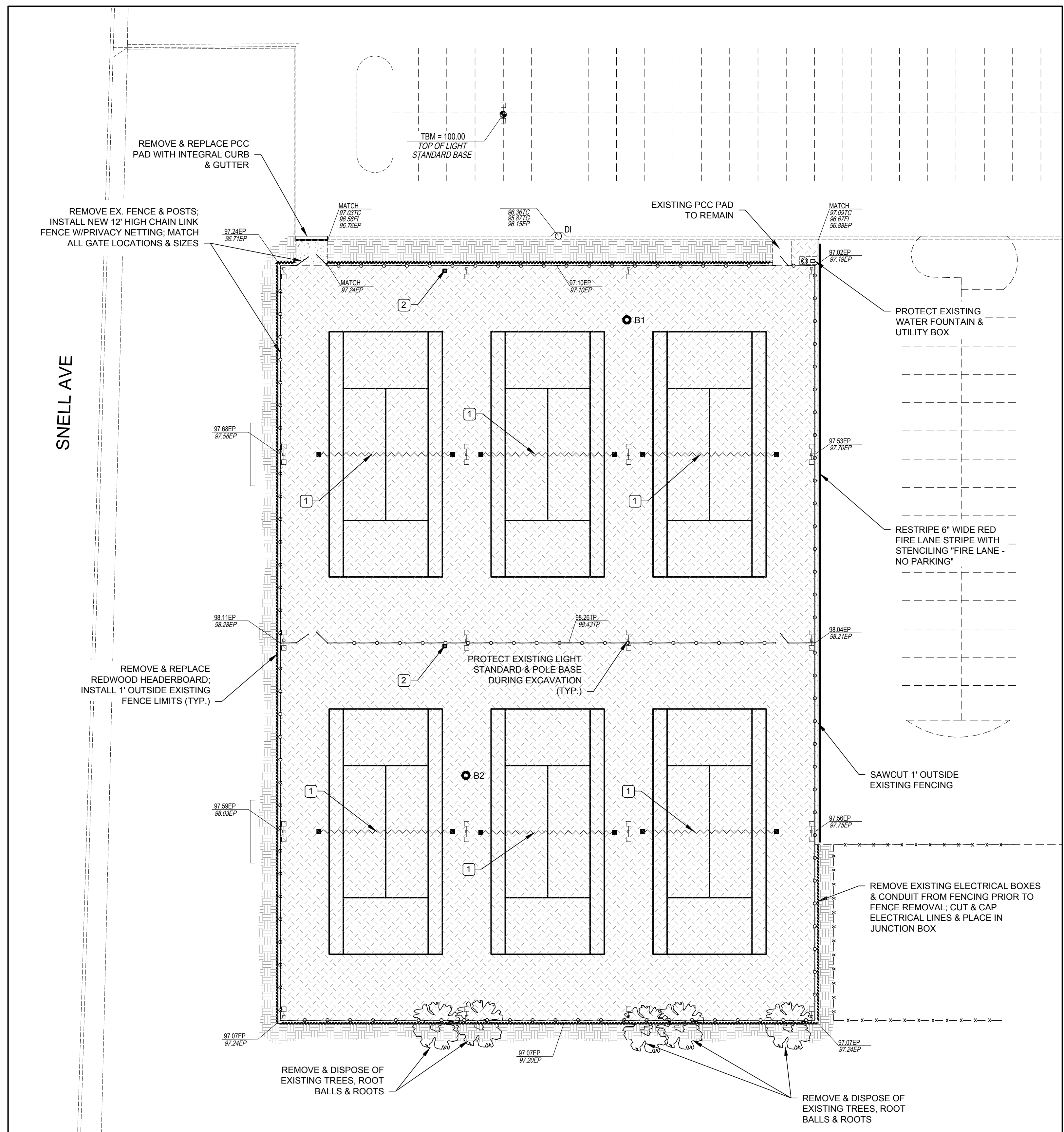

**ENLARGEMENT A**  
1" = 20'

**BORING LOG**

NO.	AC	AB	FABRIC	R-VALUE
B1	4-1/2"	7-1/2"	YES	6
B2	3 1/2"	6"	YES	--

- LEGEND**
- EXCAVATE EXISTING MATERIAL TO A DEPTH OF 6"; LIME/CEMENT TREAT TO A DEPTH OF 8" & PLACE 3.5" HMA
  - REMOVE & REPLACE PCC FACILITIES (SEE PLAN)
  - EXCAVATE & REMOVE EX. VEGETATION & SOIL TO REQUIRED DEPTH; PLACE 2" TOP SOIL & RESEED
  - REMOVE & REPLACE PCC CURB & GUTTER
  - REMOVE & REPLACE (OR) INSTALL REDWOOD HEADERBOARD
  - REMOVE EXISTING POSTS & FENCING; INSTALL NEW 12' HIGH CHAIN LINKING FENCING WITH NEW GATES & PRIVACY NETTING
  - EXISTING FENCE TO REMAIN
  - DI DROP INLET
  - (OR) EXISTING LIGHT STANDARDS
  - # BORE LOCATION (SEE BORING LOG)
  - XX.XX / XX.XX DESIGN ELEV. / EXIST. ELEV.
  - EP EDGE OF PAVEMENT
  - FL FLOWLINE
  - TC TOP OF CURB
  - TP TOP OF PAVEMENT
  - TEMPORARY BENCHMARK

- NOTE:**
- 1 CONTRACTOR SHALL REMOVE & DISPOSE OF EX. TENNIS COURT HARDWARE, POST & POST BASES. CONTRACTOR SHALL INSTALL NEW PW ATHLETIC TENNIS COURT HARDWARE MODEL NO. 2205-GR (POSTS), MODEL 8352 (PREMIUM TENNIS NET), MODEL NO. 8371-20 (GROUND ANCHOR), MODEL 8371-30 (NET TIE DOWN STRAP), AND ALL OTHER MFG. REQUIRED PARTS FOR INSTALLATION. INSTALL PER MFG. RECOMMENDATIONS.
  - 2 PROTECT EXISTING ELECTRICAL LINE AND JUNCTION BOX DURING CONSTRUCTION; REFASTEN TO FENCING.

REV	DATE	DESCRIPTION	APP

**Pavement Engineering Inc.**  
You can ride on our reputation  
Corporate Office:  
3485 Sacramento Drive, Suite A  
San Luis Obispo, CA 93401  
805.781.2265

**SANTA TERESA HIGH SCHOOL**  
**6150 SNELL AVENUE, SAN JOSE, CA**  
**DW INFRASTRUCTURE - PLAY COURT IMPROVEMENTS**  
**ENLARGEMENT A**

DRAWN BY:	TL5
PROJECT NUMBER:	180390-01
SCALE:	1" = 20'
DATE:	JAN. 2019
SHEET NUMBER:	2 of 3

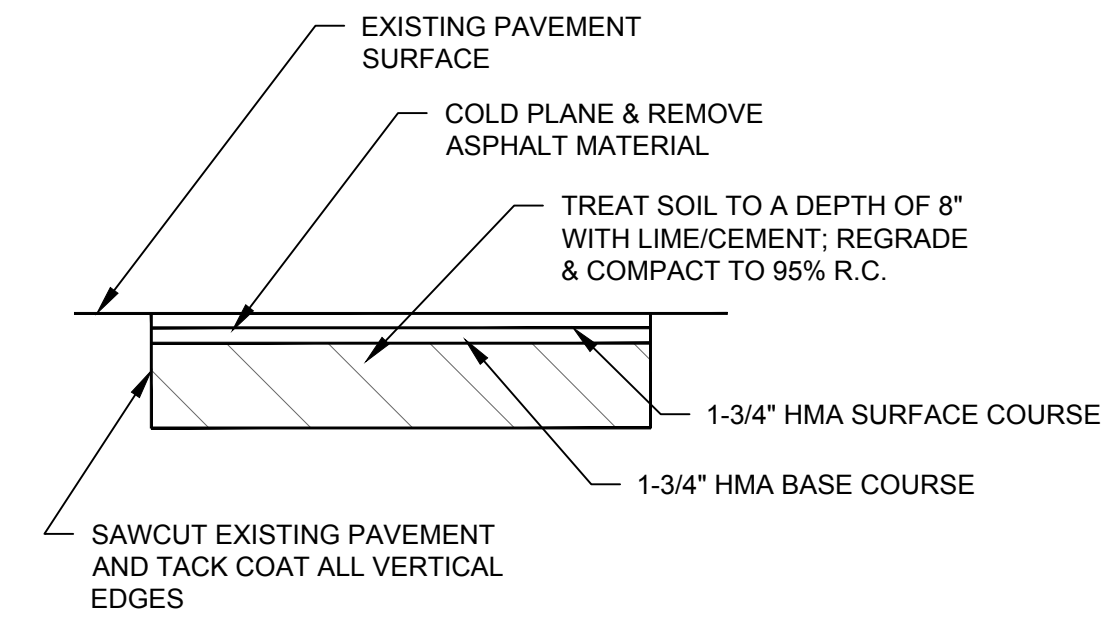

**REMOVE 6" AC/AB; LIME/CEMENT TREAT MATERIAL TO A DEPTH OF 8" & PLACE 3.5" HMA**  
NTS

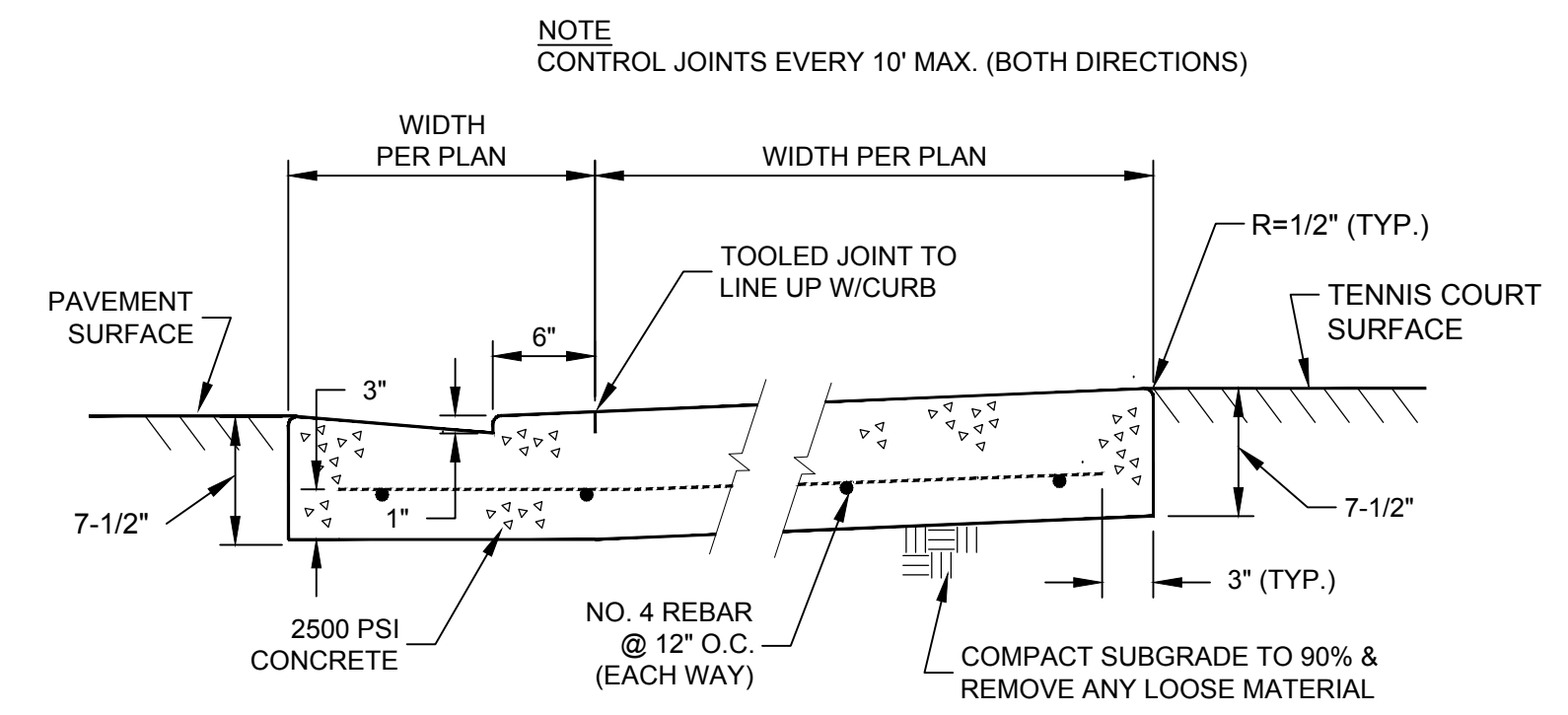

**PCC PAD WITH CURB & GUTTER DETAIL**  
NTS

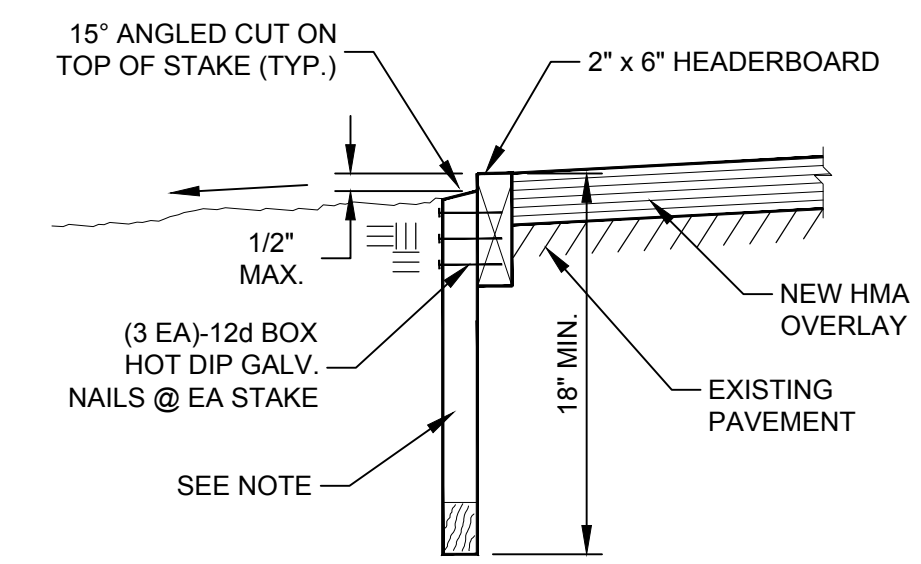

**2x6 HEADERBOARD DETAIL**  
NTS

REV	DATE	DESCRIPTION	APP

**Pavement Engineering Inc.**  
You can ride on our reputation

Corporate Office:  
3485 Sacramento Drive, Suite A  
San Luis Obispo, CA 93401  
805.781.2265

**SANTA TERESA HIGH SCHOOL**  
**6150 SNELL AVENUE, SAN JOSE, CA**

**DW INFRASTRUCTURE - PLAY COURT IMPROVEMENTS**  
**DETAILS**

DRAWN BY:	TL5
PROJECT NUMBER:	180390-01
SCALE:	NOT TO SCALE
DATE:	JAN. 2019
SHEET NUMBER:	3 of 3